

Tulane MakerSpace

Electronics Lab
Training
Presentation

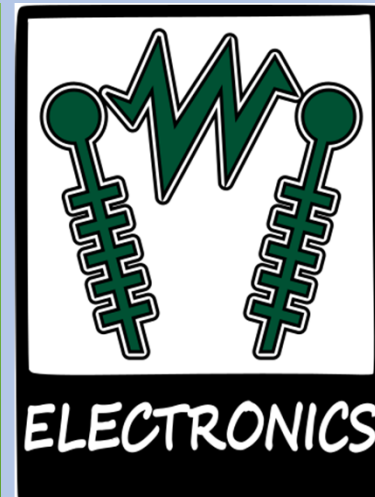

Electronics Lab



- **The electronics area is located in the upstairs (Mezzanine) section of the MakerSpace.**
- **The Electronics Lab is a “gray zone”, meaning no specific Personal Protective Equipment (PPE) is required to enter. However there are rules and some tools that require basic safety training.**

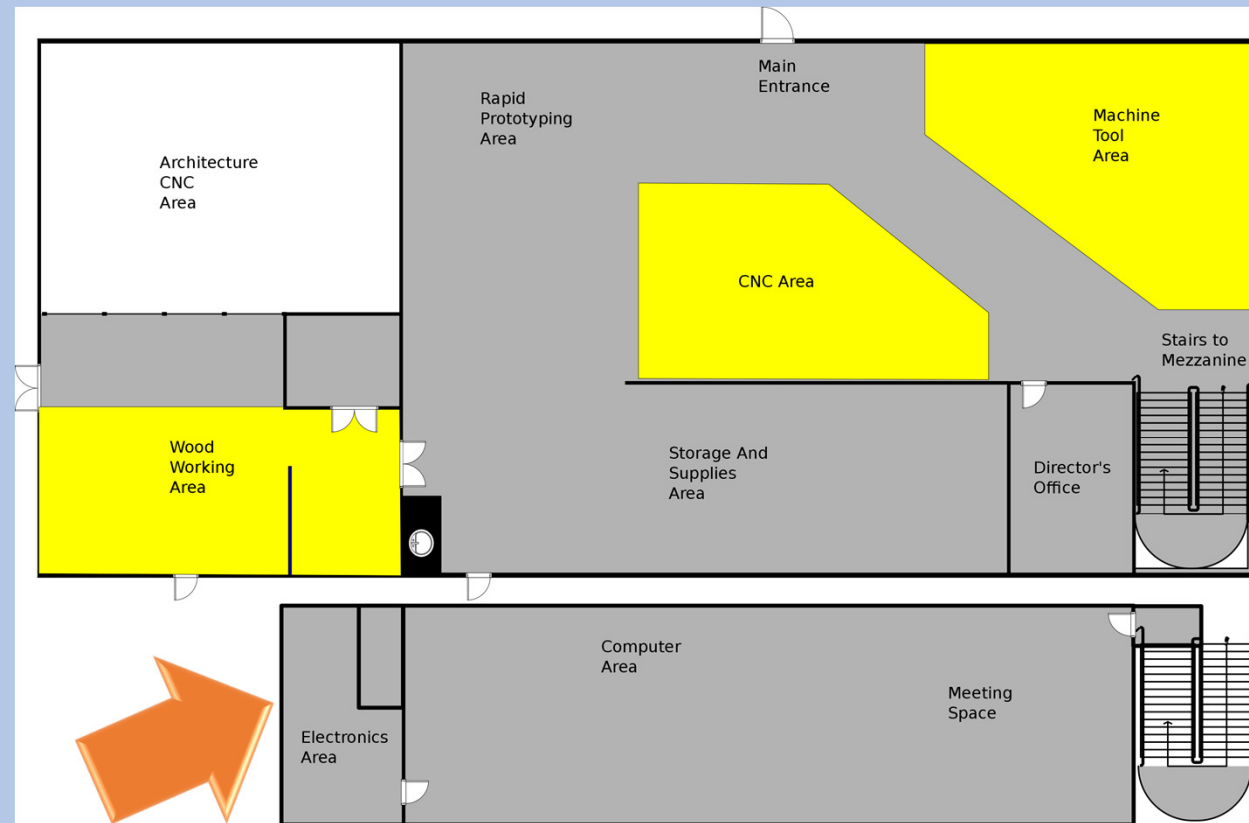

Electronics Lab



➤ Electronics Lab Rules:

➤ **All required PPE must be used as specified by each tool.**

Tools which require safety glasses:

- Soldering Irons
- Wire Cutters
- Wire Strippers
- Dremel Tools
- Cordless Drills
- Other Cutting Tools (like x-acto knives)

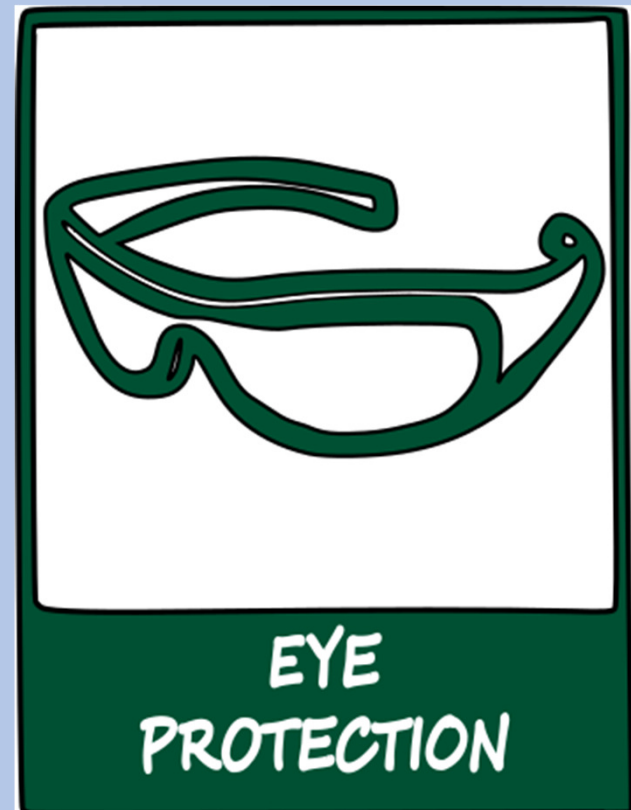

Electronics Lab



➤ Electronics Lab Rules:

➤ **All required PPE must be used as specified by each tool.**

Heat Guns and Reflow Stations require safety glasses and recommend safety gloves.

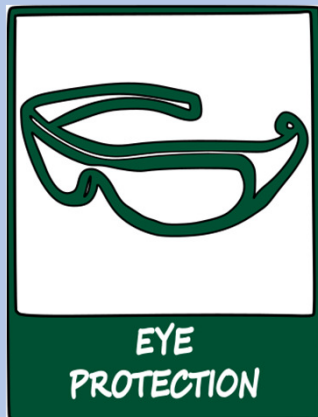

Working with Lead-Based Solder requires the use of a Fume Extractor.



Electronics Lab



➤ Electronics Lab Rules:

- **High Voltage equipment is not allowed in the Electronics Lab.**
 - **No neon signs or Tesla coils.**
- **Wet-cell (lead-acid) batteries are not allowed in the Electronics Lab.**
 - **No car or marine batteries.**
- **If you have a project that requires high voltage, high power, or wet-cell batteries, please contact the Maker-In-Chief to discuss a safe method of working with it.**

